



## HB 520

### STAIR RAIL BRACKET

The Halliday + Baillie HB 520 Stair Rail Brackets are designed for a round 30-50mm ( 1.18"-2.00" ) diameter rail.

Suitable for interior or covered exterior situations. For exterior or marine environments, please specify the HB 530 bracket in marine grade 316 series stainless steel.

**Total projection from wall :** 100 ( 3.93" )

**Overall height (upstand) :** 65 ( 2.56" )

**Material :** non-anodized aluminum alloy

**Recommended Spacing :** 23"-32"

Standard HB 520 set includes all fasteners. Epoxy sold separately. Please contact your account manager for guidance.

Available in all standard finishes except Brushed Nickel (BN). See finishes sheet for more information.

#### Certifications :

Halliday+Baillie brackets are tested in accordance with both the AS/NZS 1170.1:2002 (Structural Design Actions) standards and the International Building Code, IBC (2003) to comply with the 200 lb. fall rating.

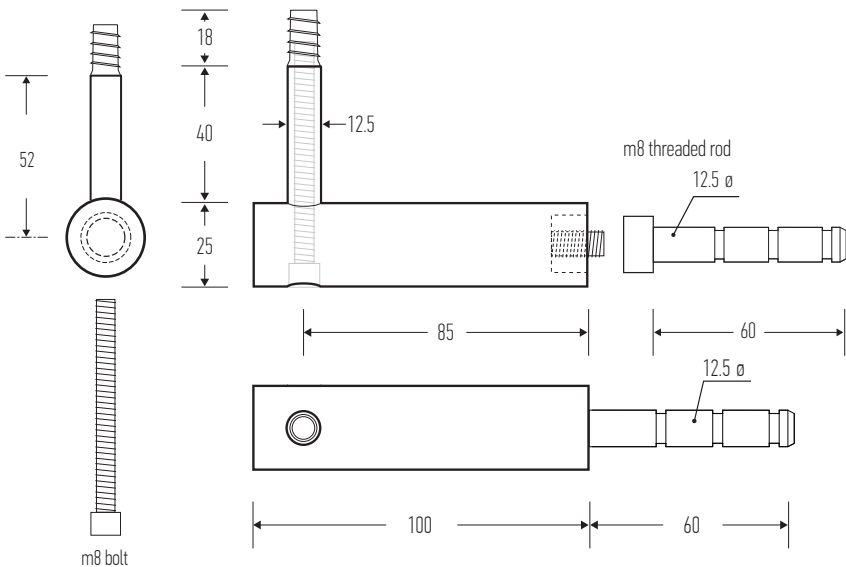

## HB 522

### GLASS FIXING KIT FOR HB 530 BRACKET

Suitable for 3/8"-1/2" thick glass. Available for thicker glass on request. Finishes available to match HB 520 Bracket.

