

**halliday
baillie**

HB 690/35

POCKET DOOR PRIVACY SET : 55mm Backset

The iconic Halliday+Baillie HB 690/35 sliding door privacy set features an integrated push button-activated edge pull for pocketed doors. The operable "snib" (a slide block that acts like a traditional thumb turn) slides upwards to engage the lock. The discrete emergency release indicator pull can be operated with a pen or other object to disengage the lock from the outside.

In double door conditions, for the passive leaf specify the HB 697 Strike Body w/Edge Pull and add HB 660/35 Flush Pulls where a matching face plate is required.

Backset : 55 (2.17")

Recommended minimum door thickness : 1-3/8"

Flush pulls : 170 (6.69") x 36 (1.42") x 12 (0.47")

Internal grip depth : 11 (0.43")

Suitable for wide stile timber or aluminium doors

Standard HB 690/35 set includes :

- HB 690 Series Lock Body
- Two HB 660/35-style Flush Pulls (one for HB 693)
- Two HB 604 Fixing Kits (one set for HB 693)
- Strike and Dust Box
- Two spindle lengths (please specify door thickness)
- Fasteners

For all configurations see other side.

Available in all standard Halliday+Baillie finishes.
See finishes sheet for further details.



HB 690 Lock Body

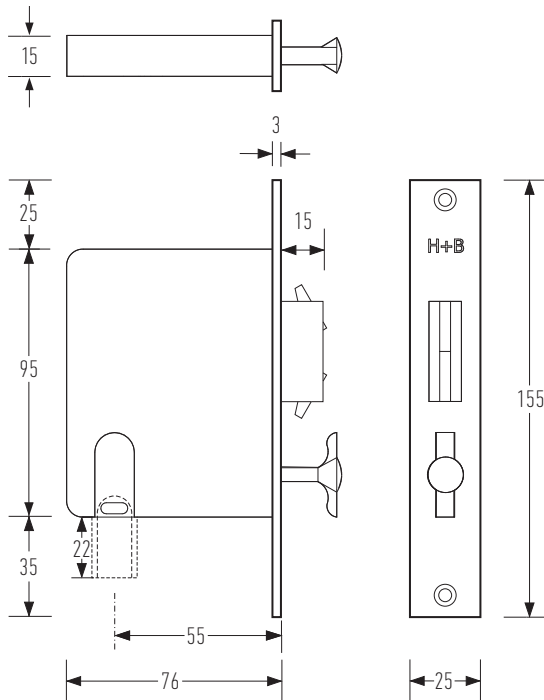

NOTE : To order these locksets without the edge pull function, specify No Pop Out version.

All information on this product page is subject to change.
LIT-HALLB-023 BW22-031 05.2022

© 2021 Halliday+Baillie Ltd.

Designed and manufactured in New Zealand.
For more information on all of our products
please visit: HallidayBaillie.com
For dealers in North America contact:
Bridgeport Worldwide : +1-800-362-1484
BridgeportWorldwide.com/hallidaybaillie



Snib



Emergency Release



dustbox and strike plate



To be used with the HB 604
Timber Fixing Kit for wood doors

HB 690/35 LOCKSETS CONFIGURATIONS



HB 690/35
Privacy Set
Snib In
Emergency Release Out



HB 692/35
Snib In
Blank Out

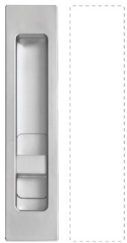

HB 693/35
Snib In
None Out



HB 694/35
Snib Both Sides

HB 690/35 Flush Pulls

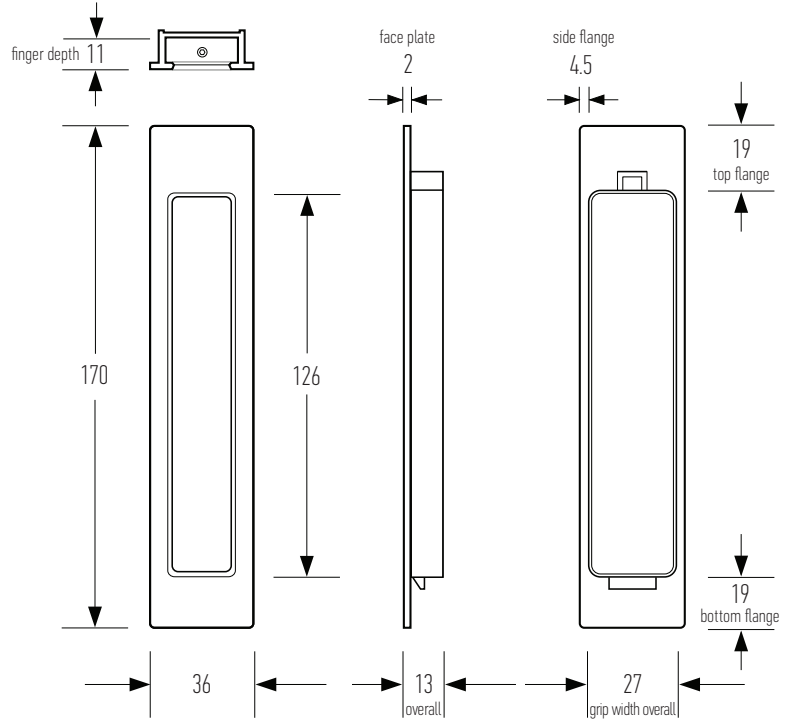

Related Products



HB 660



HB 670



HB 675



HB 680



HB 697



HB 678

INSTALLATION NOTES :

Flush pulls are designed to be mounted with the body within the thickness of the door, and the face surface mounted - total projection is 2mm. Fully recessed mounting is possible on timber doors with the appropriate door thickness. Using glue, epoxy or silicone products etc to secure flush pulls to the door is not required or recommended for installation, and may void warranty. Glue, epoxy, or silicone products can be used to secure the spindle to the back of the snib flush pull for example where sets have a flush pull to one side only.

For detailed information on these finishes please consult the finish guide. For finish samples contact your account manager.

FINISHES



BN



KC



ORB



PC



SC



EBA



EDB



EMB



EFW



WHT